

STANDARD DC BEACONS

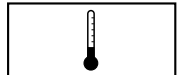

1 Hz Nom.



-20°C to +40°C



IP65

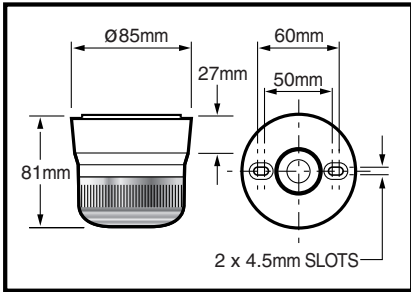

1

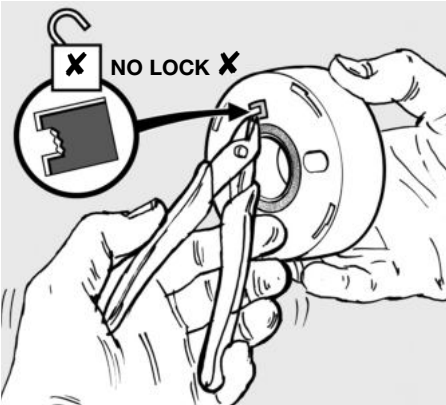

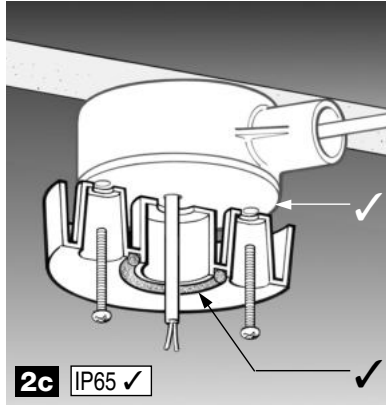
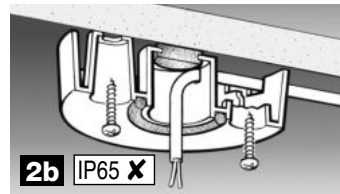
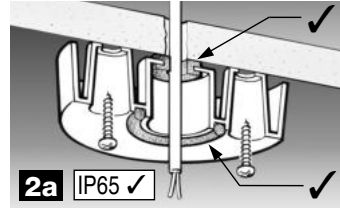

2

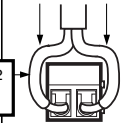

3**12V** 
(±15%)

+12V 0V

1.5mm²
max**24V** 
(±15%)



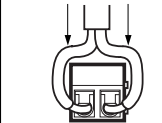

0V +24V

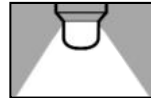
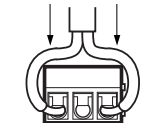
**3 WIRE LED 11-35V** 

+11-35V 0V

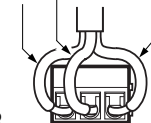
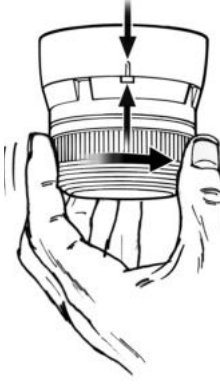
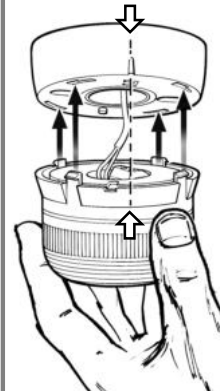
**OR**0V = 

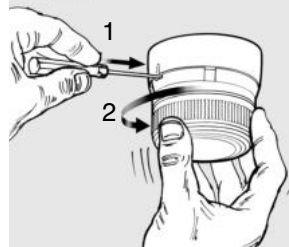
+11-35V 0V

**4****TO REMOVE** **WITH LOCK**  **NO LOCK** 